



CAMEROON GENERAL CERTIFICATE OF EDUCATION BOARD

Technical and Vocational Education Examination

JUNE XXXX

INTERMEDIATE LEVEL

Subject Title	WORKSHOP PROCESSES AND MATERIALS 3
Subject Code No.	5395
Paper No.	THREE

THREE HOURS

INSTRUCTIONS

1. The paper is presented as section A and B.
2. Answer any three of the four questions on section A and any one of the two questions on section B.
3. All questions carry equal marks.
4. This paper will carry a weighting of 35 % of the total marks allocated for the subject.
5. Read each question carefully before commencing your answers.
6. Use sketches and diagrams wherever these will help your answer in addition to those questions where drawing is compulsory.
7. Written answers should be brief and to the point.
8. You are allowed to use your drawing instruments and calculator.

You are reminded of the necessity for good English and orderly presentation in your answers.

A command is placed under your care for the production of a trash can that will be fitted on a recycling machine of used plastic, in a metallic workshop, where you are working as a technician.

With the available manual, mechanical and thermal equipments, you are required to construct the trash can on page 3.

MATERIALS NEEDED

- Drawing board
- Tee square
- Set square 45, 30 & 60
- Card board paper
- Sheet 10/10

EQUIPMENT/MACHINES

- An oxy-acetylene plant
- Rolling machine
- Grinding machine
- Drilling machine

TOOLS

- Scriber
- Rule
- Tape
- Snip

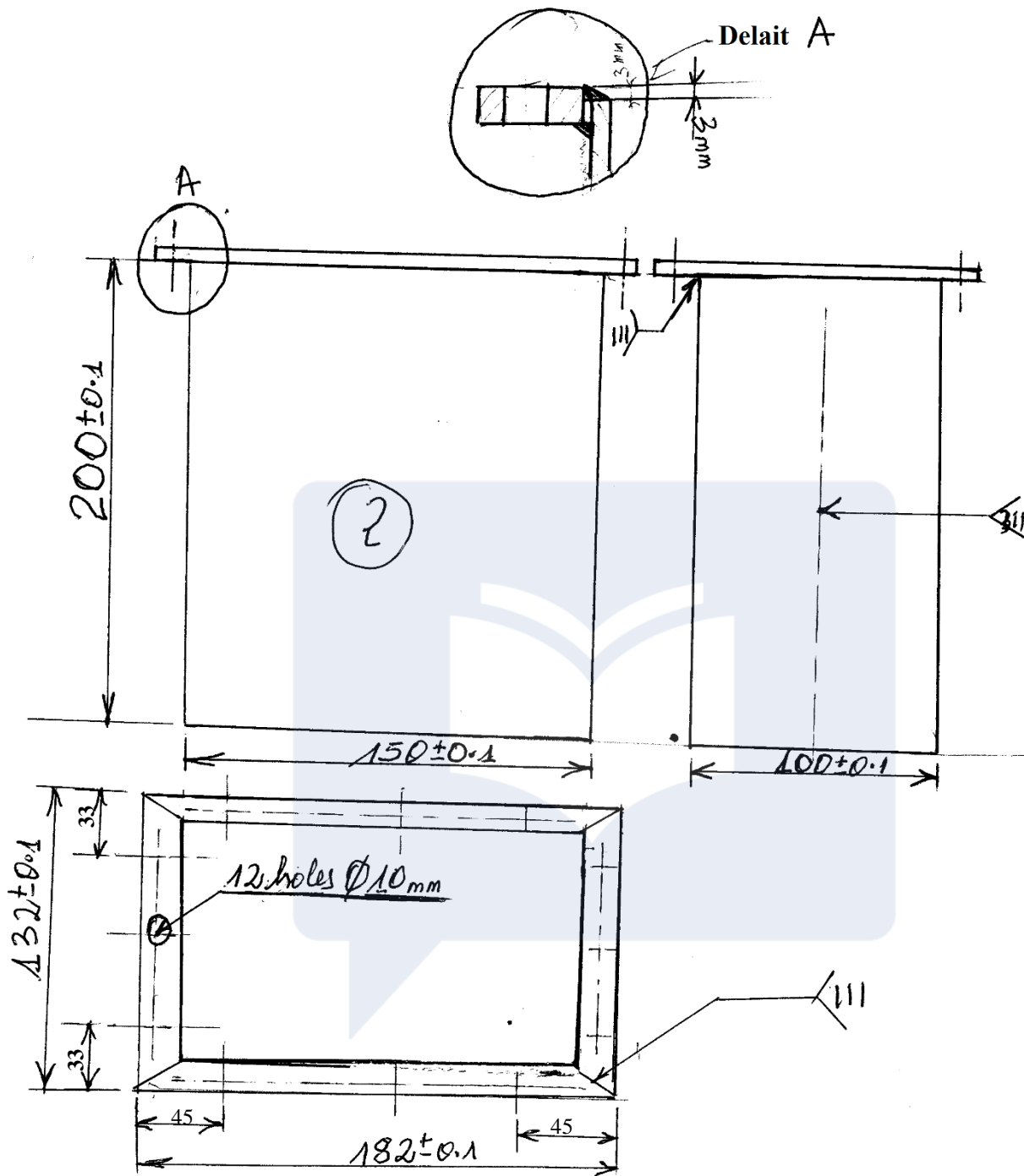

3	1	BOTTOM	155mm X 105 mm	Sheet 10/10
2	1	BODY	520 mm x 210 mm	Sheet 10/10
1	1	FLANGE	620 mm	Flat bar 16/3
REF	No	DESIGNATION	NATERIAL	OBSERVATION

MARKS DISTRIBUTION	
Forming of body	/10 marks
Dimension 200±1	/5 marks
Dimension 150±1	/ 5mks
Dimension 100±1	/5Mks
Assembling	
Cutting of bottom plate 150 x100	/15Marks
Dimension 182±1	/5Mks
Dimension 132±1	/5Mks
Assembly of flange	/15Mks
Drilling of Ø12 hole	/10Mks
Welding (bottom and flange)	/15Mks
Finishing	/10 Marks
Total	100Marks

CUTTING LIST

WORKING MATERIAL

- A sheet metal of S235, of thickness 10/10 and of dimension 170 x 120
- A sheet metal of S235 of thickness 10/10 and of dimension 550 x 220
- flat bar length 700 mm;
- 1 meter filler rod.

TOOLS

- Marking-out, and forming tools.
- Welding mask
- Welding google
- A set of leather gloves.

EQUIPMENT/MACHINES

- Oxy-acetylene welding post
- Bending machine
- Liver shear
- Straight snip