



CAMEROON GENERAL CERTIFICATE OF EDUCATION BOARD

Technical and Vocational Education Examination

JUNE XXXX

INTERMEDIATE LEVEL

Subject Title	SHEET METAL WORK 2
Subject Code No.	5405
Paper No.	TWO

DURATION
THREE HOURS

INSTRUCTIONS TO THE CANDIDATES

- 1- Answer the two questions on the question paper
- 2- This paper will carry a weighting of 35% of the total marks allocated for the subject
- 3- Read each question carefully before commencing your answers
- 4- Use sketches wherever these will help your answer in addition to those questions where drawing is compulsory
- 5- You are allowed to use your drawing instruments and calculator
- 6- In all cases involving calculations, you are advised to show all the steps in your marking

You are reminded of the necessity for good English and orderly presentation in your answers.

SHEET METAL WORK

I- TARGETED SKILLS

The purpose of this analysis is to assess the following skills in the candidate:

- Develop the detailed realization process;
- Prepare the profiles;
- Form the profiles
- Assemble the profiles;
- Check the parts made.

II- APPLICATION

The drawing shown below is Duspan. It consists of sheet metal 15/10. The whole frame is welded by an electric arc with coated electrode.

The pattern will be assembled using arc welding and bolt

ANALYSIS.....

This part is theoretical and takes place in a technology room or classroom under the same conditions as a written test..

WORK REQUIRED

In order to realize this assembly, you are asked to:

1) Complete the phase planning sheet

- Correct scheduling of operations ; /10mrks
- Respect of assembly order of parts. /10mrks
- Assembled drawing /5mrks

2) Complete the manufacturing range sheet page

- Correct order of phases, /8Mks
- Correct order of sub-phases, /8Mks
- Correct order operations; /8Mks
- Designation, /10Mks
- Dimension accuracy; /10Mks
- Sketch and set-up of machining /25Mks
- Correct choice of control tools /6Mks

Total / 100Mks

ASSEMBLY DRAWING

DETAIL DRAWING

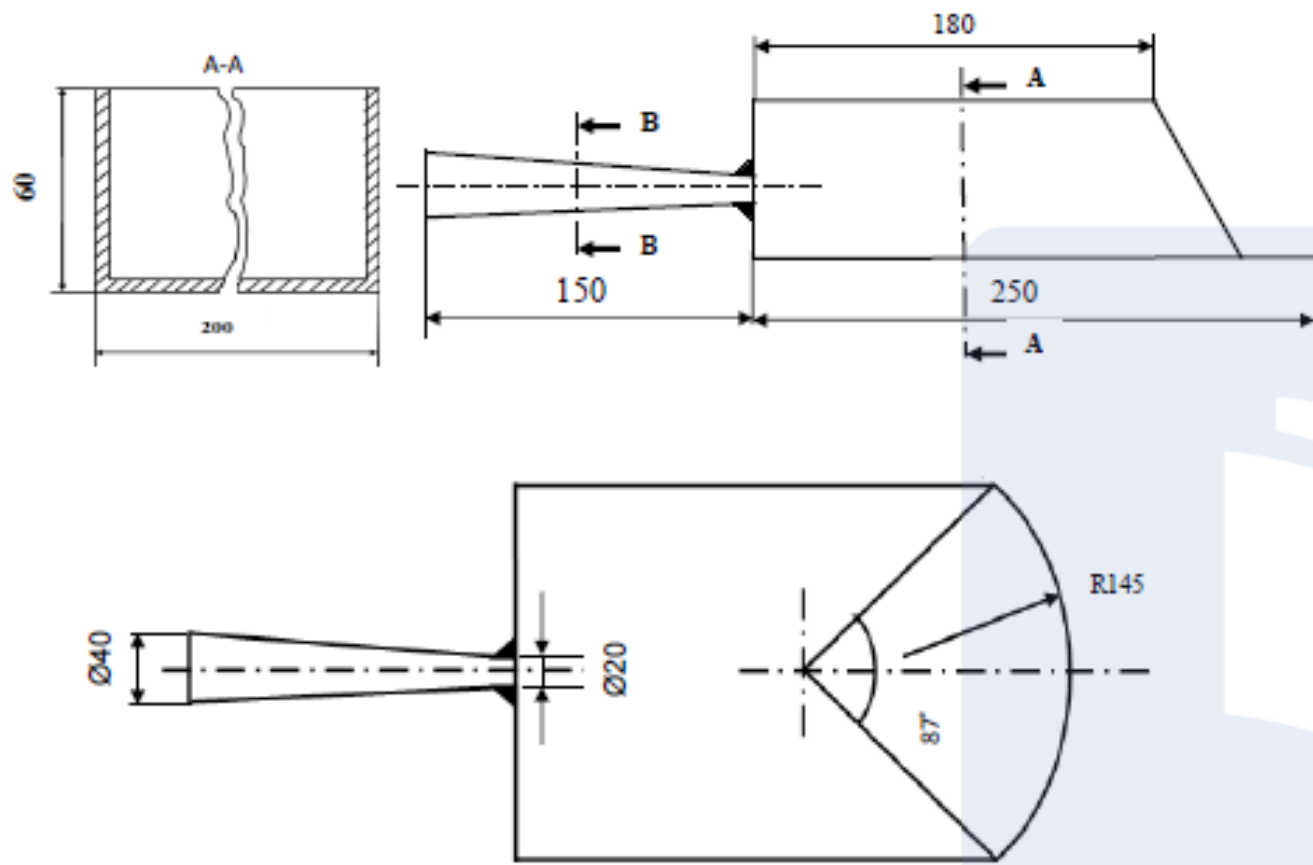

Handle: reference 1

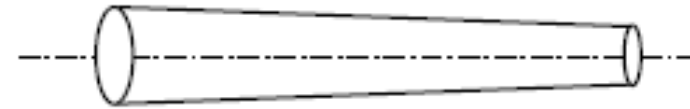

Cover: reference 2

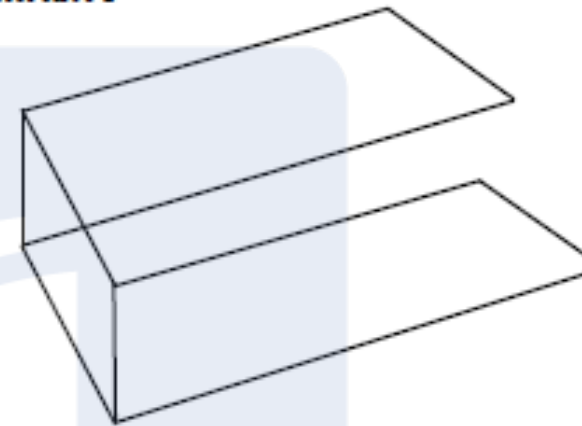

Support: Reference 3

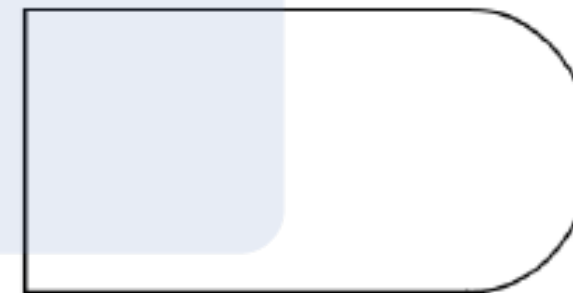

NB: sheet thickness is 15/10

3	1	SUPPORT	S 185	
2	1	COVER	S 185	
1	1	HANDLE	S 185	
Ref.	Qty	Designation	Material	Observation
Scale: 1:2				
DETAIL DRAWIND OF THE DUSTPAN				

Turn Over XXXX/5405/2C

Session			MANUFACTURING RANGE
Phase	Sub-Phase	Elements	MANUFACTURING DRAWING
			ASSEMBLED PROJECT

