

GENERAL CERTIFICATE OF EDUCATION BOARD
Technical and Vocational Education Examination

JUNE 2025

KAWLO

INTERMEDIATE LEVEL

Specialty Name and Acronym	Civil Engineering Building Construction - CE-BC (F4 BA)
Centre No.	
Centre Name	
Candidate Identification No.	
Candidate Name	

Mobile phones are NOT allowed in the examination room.

5200 CONSTRUCTION PROCESSES AND BUILDING PRACTICE 1: MULTIPLE CHOICE QUESTION PAPER

Duration: One and a Half Hours

INSTRUCTIONS TO CANDIDATES

Read the following instructions carefully before you start answering the questions in this paper. Make sure you have a soft HB pencil and an eraser for this examination.

1. USE A SOFT HB PENCIL THROUGHOUT THE EXAMINATION.
2. DO NOT OPEN THIS BOOKLET UNTIL YOU ARE TOLD TO DO SO.

Before the examination begins:

3. Check that this question booklet is headed "Intermediate Level - 5200 CONSTRUCTION PROCESSES AND BUILDING PRACTICE 1."
4. Fill in the information required in the spaces above.
5. Fill in the information required in the spaces provided on the answer sheet using your HB pencil:

Candidate Name, Exam Session, Subject Code, and Candidate Identification Number.

Take care that you do not crease or fold the answer sheet or make any marks on it other than those asked for in these instructions.

How to answer the questions in this examination:

6. Answer ALL the 50 questions in this Examination. All questions carry equal marks.
7. Each question has FOUR suggested answers: A, B, C and D. Decide which answer is correct. Find the number of the question on the Answer Sheet and draw a horizontal line across the letter to join the square brackets for the answer you have chosen.

For example, if C is your correct answer, mark C as shown below:

[A] [B] [C] [D]

8. Mark only one answer for each question. If you mark more than one answer, you will score a zero for that question. If you change your mind about an answer, erase the first mark carefully, then mark your new answer.
9. Avoid spending too much time on any one question. If you find a question difficult, move on to the next question. You can come back to this question later.
10. Do all rough work in this booklet, using, where necessary, the blank spaces in the question booklet.
11. Texts, notes and pre-prepared materials of any kind are also NOT allowed in the examination room.
12. At the end of the examination, the invigilator shall collect the answer sheet first and then the question booklet. DO NOT ATTEMPT TO LEAVE THE EXAMINATION HALL WITH IT

Turn Over

1. A Wall constructed to give lateral support to an existing wall is
- Embankment wall
 - Retaining wall
 - Parapet wall
 - Buttress

2. The term 'ledger' in scaffolding is defined as
- The horizontal member of a scaffold
 - The vertical member of a scaffold
 - The diagonal member of a scaffold
 - The cross brace member of a scaffold

3. Pile foundations are suitable for
- Water logged soil
 - Multi-storey buildings
 - Compacted soils
 - Domestic building.

4. Basement wall is a wall that supports
- Heavy loads
 - Vertical loads only
 - Vertical and horizontal loads
 - Horizontal loads only

5. Which of the following shapes in figure I is a cylinder

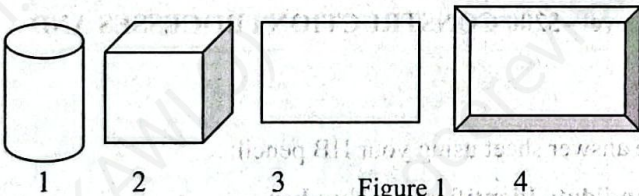

- 1
- 2
- 3
- 4

6. Home comb Walls are also called
- Curtain walls
 - Breast walls
 - Sleeper walls
 - Base walls

7. The depth of an arch is the distance between
- The crown and springing line
 - The crown and ground level
 - The intrados and extrados
 - Ground level and springing line

8. Walls constructed above the roof are
- Cavity walls
 - Sleeper walls
 - Parapet walls
 - Curtain walls

9. The name given to the type of foundation in figure 2 is



- Raft foundation
- Pad foundation
- Stepped foundation
- Pile Foundation

10. From figure 3, calculate the side A

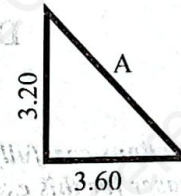

- 4.82 m
- 4.80 m
- 4.58 m
- 4.00 m

11. Given that $2R+G=0.65m$, Calculate G IF $R=17$

- 31 m
- 34 cm
- 31 cm
- 0.34 m

12. Foundations are placed below ground level in order to increase

- Stability of the structure
- Strength of the structure
- Workability of the structure
- Durability of the structure

13. Identify the part P as seen in figure 4

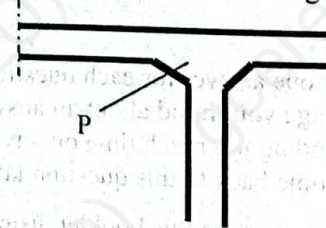

- Arm of the pillar
- The width of the pillar
- Gusset
- Cantilever

14. Weep holes are provided in retaining and breast walls to
- A Ventilate the stone masonry
 - B Drain off the water from back filling
 - C Add architectural beauty
 - D Increase compaction of the earth retained

15. The function of an over flow pipe in a water tank is to
- A Collect clean water from the roof
 - B Collect rain water from the gutter
 - C Conserved excess water
 - D Discharge excess water outside

16. The standard height of a door opening is ?
- A 1.80 m
 - B 1.70 m
 - C 2.10 m
 - D 1.90 m

17. A Technician should use a scaffold when
- A Working on a storey building
 - B Erecting pillars
 - C Working above his height
 - D Constructing upper floors

18. The lateral earth pressure exerted by a soil on a structure is called
- A Passive earth pressure
 - B Underground pressure
 - C Active earth pressure
 - D Alternative pressure

19. The forces acting on the upper part of a beam at the middle of two supports is?
- A Tensile
 - B Shear
 - C Compressive
 - D Torsion

20. The vertical part of a door frame is known as
- A Jamb
 - B abutment
 - C shutter
 - D Rebate

- Which of the following is not an electrical fitting in a domestic building
- A Current
 - B Socket
 - C Lamp holder
 - D Switch

21. Give the name of the pitched roof in figure 5

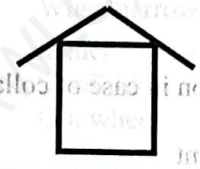

Figure 5

- A Couple roof
- B Close roof
- C Collar roof
- D Double couple roof

22. State where a flue is used in a building
- A Fire place
 - B Chimney
 - C Heating appliance
 - D Boiler

23. The name of the part of foundation as indicated with the arrow in figure 5 is

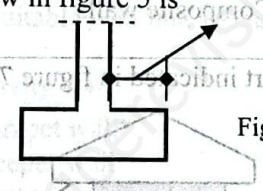

Figure 5

- A Overlap
- B Footing
- C Projecting arm
- D Lap

24. A boning rod is used for
- A Bonding of bricks
 - B Production of bricks
 - C Levelling of a trench
 - D Setting of right angles

25. An Auger is used for
- A Drilling of holes
 - B Pouring of concrete in a pile foundation
 - C Mixing of fresh concrete
 - D Levelling of sites.

26. The covering of an electric cable with plastic is known as
- A Plastering
 - B Induction
 - C Insulation
 - D Blocking

27. Constructing Soak-away on a permeable soil eases
- Excavation
 - Reconstruction in case of collapse
 - Infiltration
 - Soil movement



28. Identify a device that interrupt the flow of electricity in a house
- A Switch
 - A Cable
 - A Conductor
 - A Fuse

29. Walls constructed with more than one type of material are called
- Cavity walls
 - party walls
 - Parapet walls
 - Composite walls

30. The part indicated in figure 7 is:

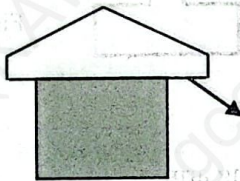

Figure 7

- Facial board
 - Soffit
 - Eaves
 - extension
31. Which of these footings are used in load bearing masonry construction ?
- Isolated
 - Raft
 - Strip
 - Pile
32. A barrier to the flow of heat in a building is called
- Sound insulation
 - Thermal insulation
 - Acoustic insulation
 - Sound and thermal insulation
33. Which bacterial breaks down effluent in a septic tank
- Anaerobic bacterial
 - Aerobic bacterial
 - Fungal bacterial
 - Oxygen bacterial

34. The function of a cleat in a roof truss is to
- Support the common rafter
 - Support purlins
 - Prevent purlins from tilting
 - Support the king post

35. With reference to figure 8, part 'B' is

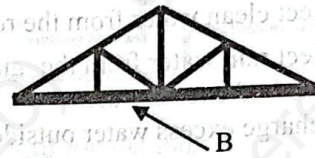

Figure 8

- King post
 - Strut
 - Horizontal member
 - Tie beam
36. The type of pointing formed by removing excess mortar from the joints is called
- Struck
 - Recessed
 - Flushed
 - Rubbed
37. The vertical distance between two treads of a staircase is
- Riser
 - Rise
 - Going
 - Landing
38. Choose from the list below one example of a non-load bearing wall
- Parapet wall
 - Curtain wall
 - Internal wall
 - Retaining wall
39. Another name for internal wall is
- Load bearing wall
 - Non load bearing wall
 - Curtain wall
 - Parapet wall
40. Which of the following is not an electrical fitting in a domestic building
- Current
 - Socket
 - Lamp holder
 - Switch

41. The personnel to whom the clerk of works is responsible is the
- A Contractor
 - B Client
 - C Quantity surveyor
 - D Structural Engineer
-
42. Choose from the list below the normal voltage of current to domestic supply
- A 240 v
 - B 320 v
 - C 120 v
 - D 220 v
-
43. A building float is used for
- A Plastering
 - B Levelling of mortar on the wall
 - C Pointing
 - D Finishing
-
44. Excessive vibration of concrete during compaction can lead to
- A Bleeding
 - B Segregation
 - C crazing
 - D shrinkage
-
45. Which of the following tools is required for dressing stones for building work ?
- A Club hammer
 - B Sledge hammer
 - C Claw hammer
 - D Builder's hammer
-
46. Materials are lifted to a working platform of a G +1 building by means of
- A Wheelbarrow
 - B ladder
 - C Scaffold
 - D Gin wheel
-
47. Which of the following foundations is not suitable for underpinning ?
- A Pile foundation
 - B Pad foundation
 - C Wide strip foundation
 - D Raft foundation
-
48. State the S.I Unit for Length
- A Kilometre
 - B Meter
 - C Hectometre
 - D Centimetre
-
49. Choose a suitable wall that supports a wooden floor
- A Cavity wall
 - B parapet wall
 - C sleeper wall
 - D Buttress wall
-
50. Which of the following is used to bridge an opening ?
- A Jamb
 - B Sill
 - C Beam
 - D Lintel
-

STOP

GO BACK AND CHECK YOUR WORK